

|      |   |
|------|---|
| Dept |   |
| Qty  |   |
| DC   | 1 |
| ED   | 1 |
| IE   | 1 |
| ISO  | 1 |
| PD   | 1 |
| R&D  | 1 |
| SD   | 1 |
| QA   | 1 |
| QC   | 1 |
| QE   | 1 |

| REV. | DESCRIPTION    | DRAWN         | CHECKED | APPROVED     |
|------|----------------|---------------|---------|--------------|
| A    | NEW RELEASE    | LJC 01/16/09  |         | LJC 01/16/09 |
| B    | DRAWING UPDATE | JLZ 06/14/19' |         |              |
|      |                |               |         |              |
|      |                |               |         |              |

The information provided herein is from CONNFLY Electronic Co., Ltd. and is confidential. Any disclosure to a party other than the recipient is prohibited. The intellectual properties and its rights contained herein, including but not limited to, trademarks, patents, copyrights, trade secrets, and technical know-how, are owned exclusively by CONNFLY or its affiliates. Unauthorized use or reproduction of any part of this document without the prior written permission of CONNFLY is strictly prohibited. CONNFLY may enforce its intellectual property rights at its own discretion, failures or delays to exercise such rights does not constitute a waiver of such rights.

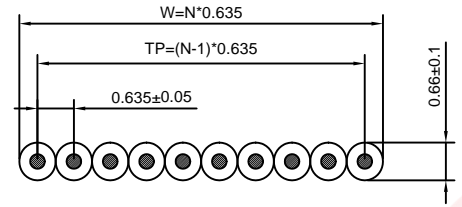

Single type

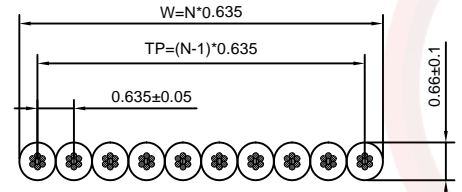

Stranded type

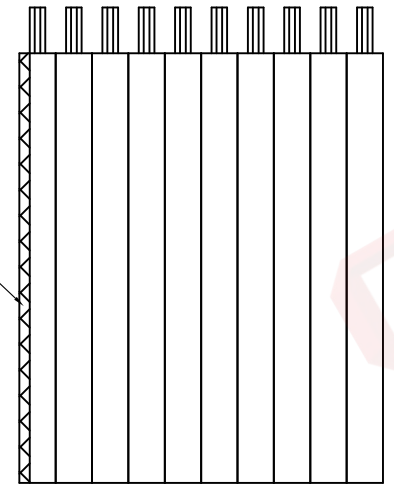

**NOTES:**

- Insulation material: PVC  
Color: Gray
- SPECIFICATION**
  - Rating: 150V
  - Conductor Size: 30AWG
  - Insulation resistance: 100MΩ/km min.
  - Contact resistance: 377Ω/km max.
  - Insulation thickness average: 7 mil.
  - Minimum insulation thickness : 6 mil.
- APPLICATION**
  - Internal wiring of computers, electronic exchanges, measurement control devices, business machines, communication devices, and other electronic equipment.

**4. Product Number Code**

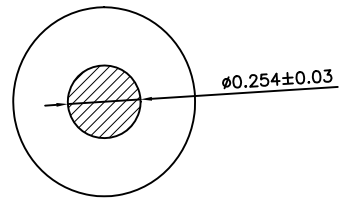
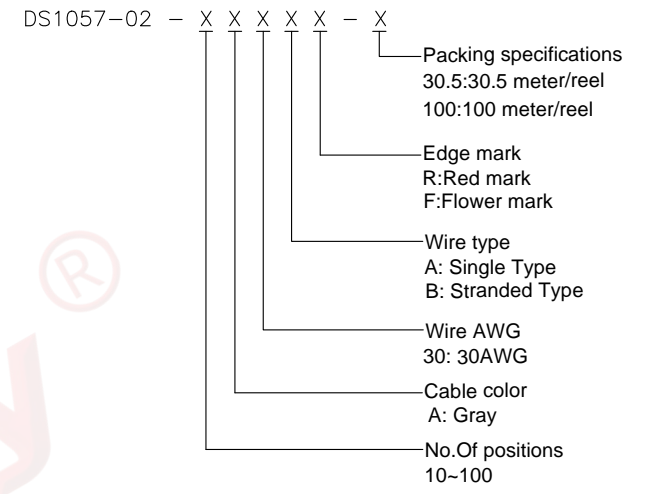

Single type

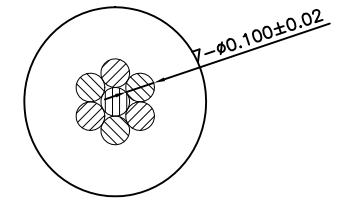

Stranded type

|                   |       |                       |              |            |  |        |                                  |  |
|-------------------|-------|-----------------------|--------------|------------|--|--------|----------------------------------|--|
| GENERAL TOLERANCE |       | ANGLE TOLERANCE       |              | PROJECTION |  | TITLE  | UL 2678 FLAT CABLE PITCH 0.635mm |  |
| X.                | ±0.60 | X.                    | ±5°          | UNITS      | mm   |        |                                  |  |
| .X                | ±0.38 | .X                    | ±3°          | SHEET SIZE | A4   | SERIES | DS1057-02 SERIES                 |  |
| .XX               | ±0.25 | .XX                   | ±2°          |            |  |        |                                  |  |
| DRAWING TYPE      |       | CUSTOMER              |              |            | 晨翔电子有限公司<br>CONNFLY CONNFLY ELECTRONIC CO. LTD |        |                                  |  |
| SCALE             |       | 1:1                   | SHEET 1 OF 1 |            |  |        |                                  |  |
| DRAWING NO.       |       | C-DS1057-02-XXXXX-X-B |              |            |  |        |                                  |  |